

# MATERIAL:

**Console:** Zinc plated, Mild Steel; AISI 430; AISI 304; AISI 316

**Clamp:** Zinc plated, Mild Steel; AISI 430; AISI 304; AISI 316

**Rubber profile:** EPDM; Neoprene; Silicon rubber

SIZES											
Clamp Minimum	Clamp Maximum	Band Width	Band W1	Thickness W4	Screw Size	Console Width	Console Length	Console Thickness	Pitch Size	Pitch hole size	Advised torque
D1	D2	B1	S1	S1	M	B2	L2	S2	A	E*F	
44	50	22	1.2	0.8	6	40	120	3	93	9*17	6 Nm
49	54	22	1.2	0.8	6	40	120	3	93	9*17	6 Nm
53	59	22	1.2	0.8	8	40	120	3	93	9*17	18 Nm
57	62	22	1.2	0.8	8	40	120	3	93	9*17	18 Nm
62	67	24	1.5	0.8	8	50	156	3	118	9*27	18 Nm
68	73	24	1.5	0.8	8	50	156	3	118	9*27	18 Nm
73	79	24	1.5	0.8	8	50	156	3	118	9*27	18 Nm
80	88	24	1.5	0.8	8	50	156	3	118	9*27	18 Nm
86	93	24	1.5	0.8	8	50	156	3	118	9*27	18 Nm
92	101	24	1.5	0.8	8	50	156	3	118	9*27	18 Nm
100	109	24	1.5	0.8	8	50	156	3	118	9*27	18 Nm
109	117	24	1.5	0.8	8	50	156	3	118	9*27	18 Nm
117	126	24	1.5	0.8	8	50	156	3	118	9*27	18 Nm
127	137	26	1.7	1	10	50	156	3	118	9*27	36 Nm
136	145	26	1.7	1	10	50	156	3	118	9*27	36 Nm
146	157	26	1.7	1	10	50	156	3	118	9*27	36 Nm
158	169	26	1.7	1	10	50	156	3	118	9*27	36 Nm
171	183	26	1.7	1	10	60	236	3	184	9*41	36 Nm
183	194	26	1.7	1	10	60	236	3	184	9*41	36 Nm
195	208	26	1.7	1	10	60	236	3	184	9*41	36 Nm
209	222	26	1.7	1	10	60	236	3	184	9*41	36 Nm
222	233	26	1.7	1	10	60	236	3	184	9*41	36 Nm
231	249	26	1.7	1	10	60	236	4	184	9*41	36 Nm
235	246	30	1.5	1.2	10	60	300	4	250	11*39	36 Nm
248	259	30	1.5	1.2	10	60	300	4	250	11*39	36 Nm
261	272	30	1.5	1.2	10	60	300	4	250	11*39	36 Nm
274	285	30	1.5	1.2	10	60	300	4	250	11*39	36 Nm
287	298	30	1.5	1.2	10	60	300	4	250	11*39	36 Nm
300	311	30	1.5	1.2	10	60	300	4	250	11*39	36 Nm
313	324	30	1.5	1.2	10	60	300	4	250	11*39	36 Nm
326	337	30	1.5	1.2	10	60	300	4	250	11*39	36 Nm
339	350	30	1.5	1.2	10	60	400	4	350	11*39	36 Nm
352	363	30	1.5	1.2	10	60	400	4	350	11*39	36 Nm
365	376	30	1.5	1.2	10	60	400	4	350	11*39	36 Nm
378	389	30	1.5	1.2	10	60	400	4	350	11*39	36 Nm
391	402	30	1.5	1.2	10	60	400	4	350	11*39	36 Nm
404	415	30	1.5	1.2	10	60	400	4	350	11*39	36 Nm
417	428	30	1.5	1.2	10	60	400	4	350	11*39	36 Nm
430	441	30	1.5	1.2	10	60	400	4	350	11*39	36 Nm
443	454	30	1.5	1.2	10	60	400	4	350	11*39	36 Nm
456	467	30	1.5	1.2	10	60	400	4	350	11*39	36 Nm
469	480	30	1.5	1.2	10	60	400	4	350	11*39	36 Nm
482	493	30	1.5	1.2	10	60	400	4	350	11*39	36 Nm
495	506	30	1.5	1.2	10	60	400	4	350	11*39	36 Nm

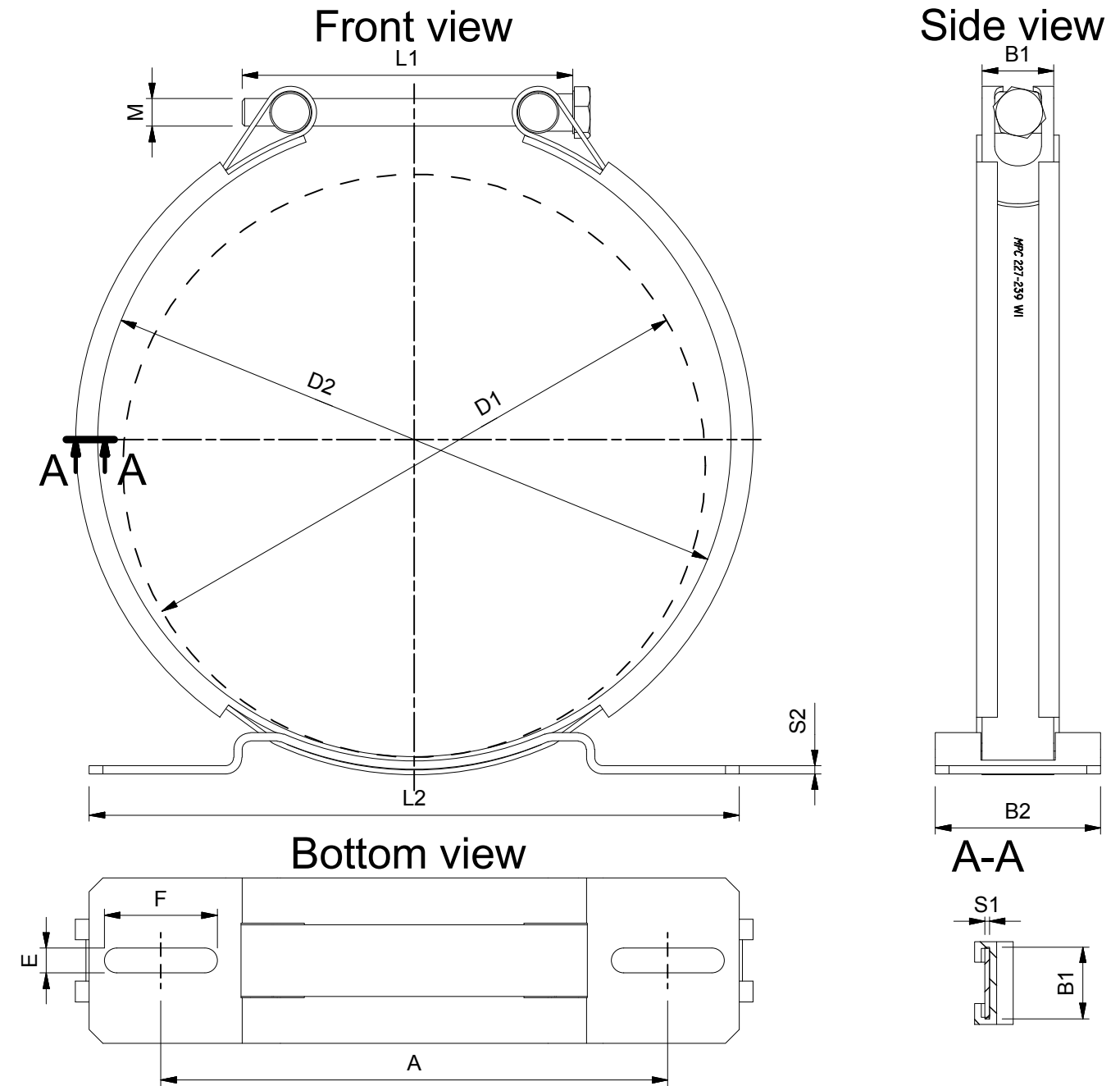

Revision history			
Rev.	Date	Description	AUTHOR
1	02/12/2015	Advised torque value added	Gy. Kardos
2	23/03/2017	Size 144mm-153mm, changed to 146mm-157mm.	Gy. Kardos

© 2013 MPC INDUSTRIES BV, developed and designed by MPC INDUSTRIES BV

General Tolerances: according to: DIN 2768-vL

SURFACE TREATMENT AND/OR PROTECTION:

NOTICE TO PERSONS RECEIVING THIS DRAWING AND/OR TECHNICAL INFORMATION:  
MPC Industries BV claims proprietary rights to the material disclosed herein. This drawing and/or technical information is issued in confidence for engineering information only and may not be reproduced or used to manufacture anything shown or referred to hereon without direct written permission from MPC Industries BV to the user. This drawing and/or technical information is the property of MPC Industries BV and is loaned for mutual assistance to be returned when its purpose has been served.  
THIS DRAWING AND/OR TECHNICAL INFORMATION IS THE PROPERTY OF MPC INDUSTRIES BV

DO NOT SCALE FROM DRAWING.

Material: \_\_\_\_\_ Dimensions: \_\_\_\_\_

Doc no.: ACCULIGHT.dwg

Third angle projection:

Part number: **ACCU-LIGHT**

Drawn by: Gy. Kardos Creation date: 02/04/2014

Checked by: M. Wiersma Checked date: 23/03/2017

Scale 1:1 Units: mm

Status: Released

Description: MPC Industries Light accumulator clamp datasheet.

Revision: **2**

Format: **A3**

MPC Industries B. V. Badweg 38 8401 BL Gorredijk Postbus 225 8400 AE Gorredijk. Tel.: . 0513 465477 Fax.: 0513 465736