

Item	Qty	PART NUMBER	Description	STOCK NUMBER	Material	Length
1	1	ESA-15164176A-01	Console	XPLAT40x3	DC01 C390	516.3 mm
2	1	ESA-15164176A-02	Lower clamp	XPLAT30x3	DC01 C390	327.4 mm
3	1	ESA-15164176A-03	Upper clamp	XPLAT30x3	DC01 C390	262.1 mm
4	2	ESA-15164176A-04	Rubber lower clamp	XRUBBER30x3	EPDM Shore 65°±5°	78.7 mm
5	1	ESA-15164176A-05	Rubber upper clamp	XRUBBER30x3	EPDM Shore 65°±5°	179.4 mm
6	4	OAA-21017135M-01	Rivet Bushing Ø21	XPROPACCUW1	11SMnPb30 / 1.0718	
7	2	OBA-12800088M-00	DIN 933 - M12x80 Sk 8.8	XBOUTM12x80	Steel, Galvanized	
8	2	OMA-12000080M-00	DIN 934 - M12 Sk.8	XMOERM12	Steel, Galvanized	



© 2017 MPC INDUSTRIES BV, developed and designed by MPC INDUSTRIES BV

General Tolerances: according to: DIN 2768-vL

SURFACE TREATMENT AND OR PROTECTION:

Zinc plated

DIN50961: Fe/Zn 8-12 µm

**Commercial
Drawing**

NOTICE TO PERSONS RECEIVING THIS DRAWING AND/OR TECHNICAL INFORMATION:
MPC Industries BV claims proprietary rights to the material disclosed herein. This drawing and/or technical information is issued in confidence for engineering information only and may not be reproduced or used to manufacture anything shown or referred to herein without direct written permission from MPC Industries BV to the user. This drawing and/or technical information is the property of MPC Industries BV and is loaned for mutual assistance to be returned when its purpose has been served.
THIS DRAWING AND/OR TECHNICAL INFORMATION IS THE PROPERTY OF MPC INDUSTRIES BV.
DO NOT SCALE FROM DRAWING.

Material: ,

Mass: 1,242 kg

Filename: ESA-15164176A-00.dwg

Sheet: 1 / 3

Third angle projection:

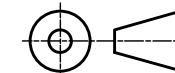

Part number:

ESA-15164176A-00

Drawn by: C.P. Dijkstra

Creation date: 11/06/2018

Checked by: M. Wiersma

Checked date: 19/06/2018

Scale 1 : 2

Units: mm

Status: Released

Description:
ESA MPC Clamp. Clamp range Ø164-Ø176

Revision:

Format:

A3